

Section View - A - Input Shaft & Retainer Assembly

Section A P/M11/14 Input Shaft and Retainer Assembly								
Balloon #	Pump/Motor	Type	Shaft Code	Rotation	Seal Code	Item #	Description	Qty
A1	P	P/V/X/S	2	**	**	033-71601-0	SHAFT KEYED	1
	M	V/H						
	P	P/V/X/S	3	**	**	033-71604-0	SHAFT SPLINED	
	M	V/H						
	P	P/V/X/S	7	**	**	*033-94180-0	SHAFT KEYED	
	M	V/H						
	P	P/V/X/S	8	**	**	*033-94181-0	SHAFT SPLINED	
	M	V/H						
	P	P/V/X/S	9	**	**	*033-94220-0	SHAFT KEYED	
	M	V/H						
	P	P/V/X/S	10	**	**	033-93608-0	SHAFT KEYED	
	M	V/H						
	P/M	R/L	2	**	**	033-92619-0	SHAFT KEYED	
	P/M	R/L	3	**	**	033-92619-0	SHAFT SPLINED	
	P/M	R/L	7	**	**	*033-04182-0	SHAFT KEYED	
	P/M	R/L	8	**	**	*033-94183-0	SHAFT SPLINED	
	P/M	R/L	9	**	**	*033-94221-0	SHAFT KEYED	
	P/M	R/L	10	**	**	033-93614-0	SHAFT KEYED	
a1-1	P	P/V/X/S/ R/L	7/8/9	**	1	671-00131-0	O RING	2
	M	V/H/R/L						
	P	P/V/X/S/ R/L	7/8/9	**	4	674-00131-0		
	M	V/H/R/L						
	P	P/V/X/S/ R/L	7/8/9	**	5	675-00131-0		
M	V/H/R/L							
a1-2	P	P/V/X/S/ R/L	7/8/9	**	**	033-71492-0	SLEEVE	1
	M	V/H/R/L						
A2	P/M	**	2/3/10	**	**	033-71641-0	RETAINING RING	2
	P/M	**	7/8/9	**	**	033-59504-0		1
A3	P/M	**	2/3/10	**	**	230-82148-0	SHAFT BEARING	1
	P/M	**	7/8/9	**	**	230-82214-0		
A4	P/M	**	2/7	**	**	033-71514-0	KEY	1
	P/M	**	9/10	**	**	033-93618-0		
A5	P/M	**	2/3/10	**	1	623-00016-0	SHAFT SEAL	1
	P/M	**	2/3/10	**	4	623-00016-4		
	P/M	**	2/3/10	**	5	623-00016-5		

Continued on next page.



Section View - A - Input Shaft & Retainer Assembly

Section A P/M11/14 Input Shaft and Retainer Assembly								
Balloon #	Pump/Motor	Type	Shaft Code	Rotation	Seal Code	Item #	Description	Qty
A7	P/M	**	2/3/10	**	1	671-00249-0	O RING	1
	P/M	**	2/3/10	**	4	674-00249-0		
	P/M	**	2/3/10	**	5	675-00249-0		
A8	P/M	**	2/3/10	**	**	033-57872-0	MECH SEAL RETAINER	1
A9	P/M	**	2/3/7/8/9/10	**	**	631-45007-0	GASKET	4
A10	P/M	**	2/3/7/8/9/10	**	**	306-40021-0	SCREW HHC	4
A11	P	P/V/X/S	7/8/9	**	**	033-91713-0	PRE=LOAD SPRING	1
A13	P	P/V/X/S/ R/L	7/8/9	**	1	671-00044-0	O RING	1
	M	V/H/R/L						
	P	P/V/X/S/ R/L	7/8/9	**	4	674-00044-0		
	M	V/H/R/L						
	P	P/V/X/S/ R/L	7/8/9	**	5	675-00044-0		
	M	V/H/R/L						
A14	P	P/V/X/S/ R/L	7/8/9	CW	**	620-82104-0	INNER SHAFT SEAL	1
	P	P/V/X/S/ R/L	7/8/9	CCW	**	620-82105-0		
	M	H/V/R/L	7/8/9	N	**	620-82116-0		
A15	P/M	**	7/8/9	**	**	620-82101-0	OUTER SHAFT SEAL	1
A16	P/M	**	7/8/9	**	**	033-91709-0	LIP SEAL RETAINER	1
A17	P/M	**	7/8/9	**	1	671-00237-0	O RING	1
	P/M	**	7/8/9	**	4	674-00237-0		
	P/M	**	7/8/9	**	5	675-00237-0		
A18	P/M	**	7/8/9	**	1	671-00251-0	O RING	1
	P/M	**	7/8/9	**	4	674-00251-0		
	P/M	**	7/8/9	**	5	675-00251-0		
A19	P/M	**	2/3/10	**	**	356-65013-0	RETAINING RING	1
A20	P/M	**	2/3/10	**	**	033-53984-0	BEARING SHIM .007**	SELECT FIT 1 ONLY
	P/M	**	2/3/10	**	**	033-53983-0	BEARING SHIM .008**	
A21	P/M	P/V/X/S/ R/L	7/8	**	**	S23-15221-0	RETAINER	1
			9			S23-19501-0		
A22	P/M	P/V/X/S/ R/L	7/8	**	**	363-12205-0	HHCS M12(1.75) x 55MM	1
			9			363-12195-0	HHCS M12(1.75) x 30MM	
A23	P/M	P/V/X/S/ R/L	7/8/9	**	**	345-10032-0	WASHER	1

NOTE: 1. ITEM NUMBERS MARKED WITH * ARE NOT USAABLE WITHOUT ITEMS a1-1 & a1-2 (O RINGS AND SLEEVE)
2. ITEMS A21, A22 AND A23 ONLY USED IN SHAFT AND SEAL RETAINER ASSEMBKY KITS.



Seal Kits Contain All Seals for the Following: NOTE: Seal kits for "M" mod pumps and for aux. pumps require part verification with HPD factory representatives. Standard Seal Kits below contain seals for the following: 1. Main Pump 2. Valve Block 3. Input/Output Controls 4. Shaft Seal					
Pump/Motor	Type	Shaft Code	Rotation	Seal Code	Part Number
P	P/V/X/R	1/2/3	**	1	S23-17032-0
				4	S23-17032-4
				5	S23-17032-5
P	S/L	1/2/3	**	1	S23-17035-0
				5	S23-17035-5
P	P/V/X/R	7/8/9	CW	1	S23-17033-0
				4	S23-17033-4
				5	S23-17033-5
P	S/L	7/8/9	CW	1	S23-17036-0
				5	S23-17036-5
P	P/V/X/R	7/8/9	CCW	1	S23-17034-0
				4	S23-17034-4
				5	S23-17034-5
P	S/L	7/8/9	CCW	1	S23-17037-0
				5	S23-17037-5

11/14 Shaft, Shaft Sleeve and O ring								
Pump/Motor	Type	Shaft	Item	Seal Code	Part Number	Description	Qty	
P	P/V/S/X	7/8/9	a1-1	1	671-00131-0	O RING	2	
M	H/V			4	674-00131-0			
				5	675-00131-0			
P	P/V/S/X	7	A	**	*033-94180-0	*SHAFT	1	
M	H/V							
P	P/V/S/X	8		**	*033-94181-0	*SHAFT	1	
M	H/V							
P	P/V/S/X	9		**	*033-94220-0	*SHAFT	1	
M	H/V							
P/M	R/L	7		**	*033-94182-0	*SHAFT	1	
P/M	R/L	8		**	*033-94183-0	*SHAFT	1	
P/M	R/L	9		**	*033-94221-0	*SHAFT	1	
P	P/V/S/X	7/8/9		a1-2	**	033-94184-0	SLEEVE	1
M	H/V							
P/M	R/L							

Note: Shaft P/N's, Item A, marked with * are not usable without o'ring, Item a1-1 and sleeve, Item a1-2

P/M11/14 Shaft and Bearing Assembly Kits Composed of Items: A1, a1-1, a1-2, A2, A3 and A4 as applicable			
Pump/Motor	Type	Shaft Code	Shaft Code
P	P/V/S/X	2	S13-43969-0
M	H/V		
P	P/V/S/X	3	S13-43968-0
M	H/V		
P	P/V/S/X	7	*S23-18182-0
M	H/V		
P	P/V/S/X	8	*S23-18183-0
M	H/V		
P	P/V/S/X	9	*S23-18268-0
M	H/V		
P	P/V/S/X	10	S23-17489-0
M	H/V		
P/M	R/L	2	S23-16255-0
P/M	R/L	3	S23-16257-0
P/M	R/L	7	*S23-18184-0
P/M	R/L	8	*S23-18185-0
P/M	R/L	9	*S23-18269-0
P/M	R/L	10	S23-17495-0

*Replacement shaft sleeves & o rings are available for Pumps Type P/V/S/X/R/L and Motors Type H/V with 7/8/9 shafts. However special tool P/N 213-0-004203 is required to remove and install the sleeve.
Note: See Page 14 for tool details.

P/M11/14 Shaft and Seal Retainer Assembly Kits Composed of Items: A1, a1-1, a1-2, A2, A3, A4, A9, A10, A13, A14, A15, A16, A17, A18, A21, A22 and A23 as applicable					
Pump/Motor	Type	Rotation	Seal Code	Shaft Code	Part Number
P	P/V/S/X	CW	1	7	S23-15219-0
P	P/V/S/X	CW	1	8	S23-15923-0
P	P/V/S/X	CW	1	9	S23-19502-0
P	P/V/S/X	CW	5	7	S23-15219-5
P	P/V/S/X	CW	5	8	S23-15923-5
P	P/V/S/X	CW	5	9	S23-19502-5
P	P/V/S/X	CCW	1	7	S23-15350-0
P	P/V/S/X	CCW	1	8	S23-15891-0
P	P/V/S/X	CCW	1	9	S23-19503-0
P	P/V/S/X	CCW	5	7	S23-15350-5
P	P/V/S/X	CCW	5	8	S23-15891-5
P	P/V/S/X	CCW	5	9	S23-19503-5
P	R/L	CW	1	7	S23-16807-0
P	R/L	CW	1	8	S23-16805-0
P	R/L	CW	1	9	S23-19504-0
P	R/L	CW	5	7	S23-16807-5
P	R/L	CW	5	8	S23-16805-5
P	R/L	CW	5	9	S23-19504-5
P	R/L	CCW	1	7	S23-16808-0
P	R/L	CCW	1	8	S23-16806-0
P	R/L	CCW	1	9	S23-19505-0
P	R/L	CCW	5	7	S23-16808-5
P	R/L	CCW	5	8	S23-16806-5
P	R/L	CCW	5	9	S23-19505-5

P/M11/14 Seal Retainer Assembly Kits Composed of Items: A14, A15 and A16					
Pump/Motor	Type	Shaft	Rotation	Seal Code	Part Number
P	P/V/X/S/R/L	7/8/9	CW	1	S23-15215-0
P	P/V/X/S/R/L	7/8/9	CCW	1	S23-15217-0
M	H/V/R/L	7/8/9	N	1	S23-16041-0

MATERIAL: MEDIUM CARBON STEEL HEAT TREATED TO 27-34 Rc

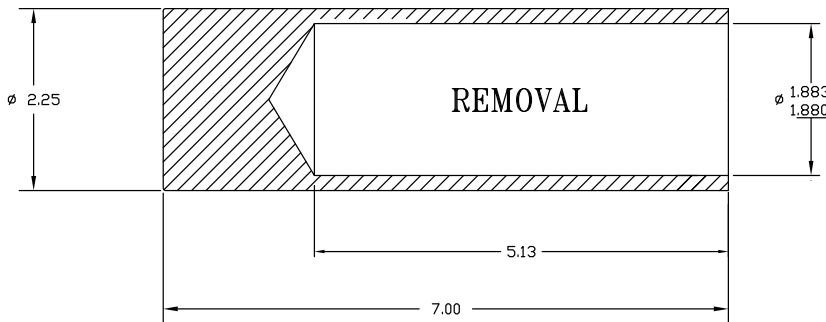
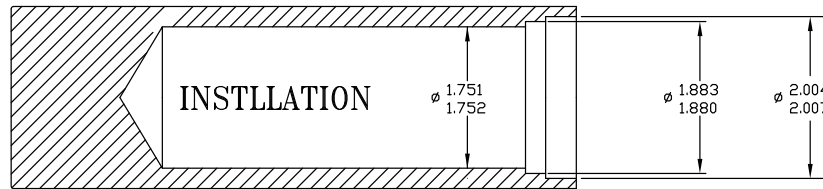

INSTALLATION

DO NOT HAMMER OR OTHERWISE IMPACT
APPLY A CONSTANT PRESSING FORCE ONLY

REMOVAL

DO NOT PRESS OFF BEARING USING SLEEVE
PRESS OFF BEARING AND THEN SLEEVE

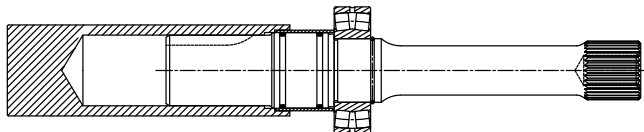

7 SHAFT

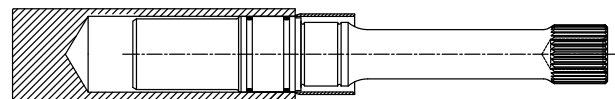

7 SHAFT

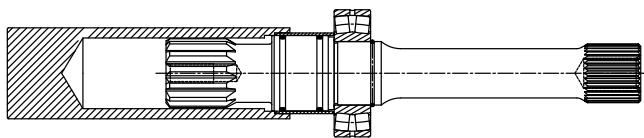

8 SHAFT

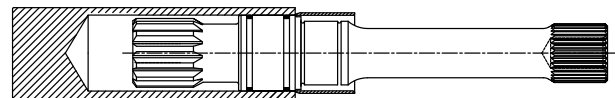

8 SHAFT

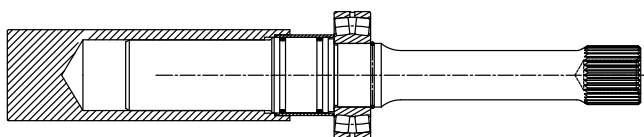

9 SHAFT

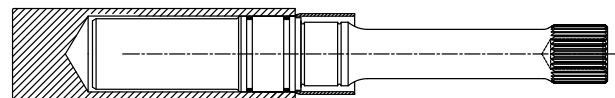

9 SHAFT